

# TECNOVIDEO

CCTV SYSTEMS AND ACCESSORIES

# EXIRLED SERIES

STAINLESS STEEL IR LED ILLUMINATOR



HAZARDOUS AREA

AISI316L STAINLESS STEEL CONSTRUCTION  
LED TECHNOLOGY  
3 BEAM PATTERNS: 15°, 19°, 34°  
SUNSHIELD FITTED AS STANDARD  
WEATHERPROOF STANDARD IP66/IP67  
REFINED AND MODERN DESIGN



EXIRLED STAINLESS STEEL INFRARED LED ILLUMINATOR WITH SUNSHIELD

## TECHNICAL SPECIFICATIONS

### GENERAL & MECHANICAL

<b>Dimensions</b>	See drawings next page
<b>Operating Temperature</b>	-20° +60°C (-4° +140° F)
<b>Construction</b>	AISI316L Stainless Steel
<b>Finish</b>	Electro-polished
<b>Mounting</b>	See drawings next page
<b>Cable entries</b>	2x M25x1,5 cable entries

Up to 4x M25x1,5 or up to 4x M20x1,5 cable entries available upon request

**Weight** Unit: 9kg; Package: 10kg

### ELECTRICAL

<b>Available voltages</b>	24VUC (24V~/V=), 115V~, 230V~ (+/-10%)
<b>Power consumption</b>	25W
<b>Activation</b>	Via Open collector/Dry contact command
<b>Light sensor photocell</b>	Input available for external "Crepuscular" activation
<b>Output</b>	Optoisolated output to provide status feedback
<b>STROBO command</b>	To synchronize video signal with FPS duty cycle
<b>Temperature protection</b>	Automatic power reduction <sup>1</sup> Automatic switch OFF <sup>2</sup>

<sup>1</sup> components temperature >60°C

<sup>2</sup> components temperature >80°C

### LED ILLUMINATOR

<b>LED</b>	14x SMD LED
<b>Wavelength</b>	850nm
<b>Beam patterns and achievable distances</b>	15° (210m), 19° (160m) or 34° (100m)

Actual illumination distance achieved may vary depending on several factors (camera/lens characteristics, reflection factor of the illuminated area, weather conditions)

### CERTIFICATIONS

<b>Ingress Protection Rating</b>	EN 60529 (IP66/IP67) ⊕ II 2 G Ex db op is op pr IIC T5 Gb -40°C ≤ Tamb ≤ +40°C ⊕ II 2 D Ex tb op is IIC T100°C Db -40°C ≤ Tamb ≤ +40°C ⊕ II 2 G Ex db op is op pr IIB T4 Gb -40°C ≤ Tamb ≤ +60°C ⊕ II 2 D Ex tb op is IIC T135°C Db -40°C ≤ Tamb ≤ +60°C
<b>ATEX Standards</b>	EN 60079-0:2012; EN 60079-1:2014; EN 60079-28:2015; EN 60079-31:2014
<b>IECEx Standards</b>	IEC 60079-0:2011; IEC 60079-1:2014-06; IEC 60079-28:2015; IEC 60079-31:2013
<b>EMC</b>	EN 61000-6-3:2007; EN 50130-4:1995 + A1:1998 + A2:2003
<b>LVD</b>	EN 60950-1:2006 + A11:2009
<b>RoHS</b>	2011/65/EU
<b>WEEE</b>	2012/19/EU

### MODELS

<b>EXIRLED1415/24</b>	Infrared LED illuminator. 15° beam pattern. Supply voltage: 24VUC
<b>EXIRLED1419/24</b>	Infrared LED illuminator. 19° beam pattern. Supply voltage: 24VUC
<b>EXIRLED1434/24</b>	Infrared LED illuminator. 34° beam pattern. Supply voltage: 24VUC
<b>EXIRLED1415/115</b>	Infrared LED illuminator. 15° beam pattern. Supply voltage: 115V~
<b>EXIRLED1419/115</b>	Infrared LED illuminator. 19° beam pattern. Supply voltage: 115V~
<b>EXIRLED1434/115</b>	Infrared LED illuminator. 34° beam pattern. Supply voltage: 115V~
<b>EXIRLED1415/230</b>	Infrared LED illuminator. 15° beam pattern. Supply voltage: 230V~
<b>EXIRLED1419/230</b>	Infrared LED illuminator. 19° beam pattern. Supply voltage: 230V~
<b>EXIRLED1434/230</b>	Infrared LED illuminator. 34° beam pattern. Supply voltage: 230V~

### MOUNTING ACCESSORIES

<b>EXSSBKIRLED</b>	Wall mounting bracket with swivel joint for EXIRLED series
<b>EXSSPMIRLED</b>	Pole mount adapter for EXSSBKIRLED bracket
<b>EXSSPTMIRLED</b>	Pole TOP mount adapter for EXIRLED series

[www.tecnovideoctv.com](http://www.tecnovideoctv.com)

Tecnovideo S.r.l. - Via San L. Murialdo, 8 36030 Villaverla (VI) ITALY - Tel. +39.0445.350444 - [info@tecnovideoctv.com](mailto:info@tecnovideoctv.com)

## STAINLESS STEEL INFRARED LED ILLUMINATOR

### DIMENSIONS

FRONT VIEW

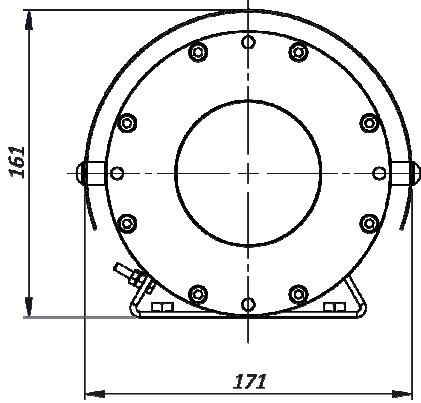

SIDE VIEW

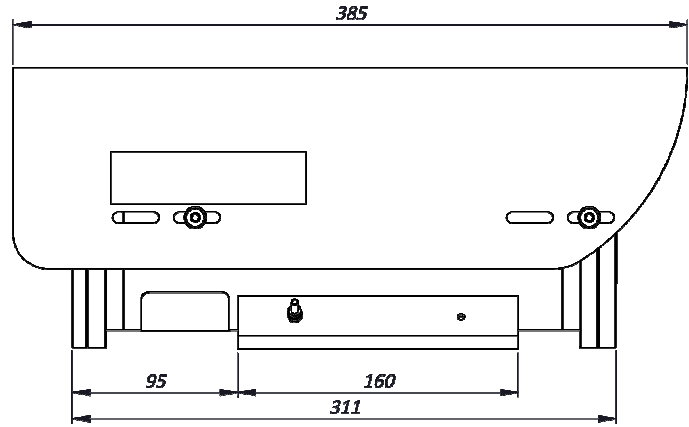

MOUNTING PATTERN

